



# Impact Resistance Systems

## Acoustichoc® & Systems



An offer  
dedicated  
to specific  
environments

New  
panel size  
600 x 600 mm

High  
acoustic  
absorption

Choice of  
**7 colors**

Resistance  
to **Ball Test**





# Impact Resistance in Educational and Sports Environments...



## Index

Resistance to Ball Test • p3

An offer dedicated to specific  
environments • p4-5

Impact Resistance Systems • p6

System's Components • p7

Acoustichoc® Panels • p8



# Resistance to Ball Test

Resistance to impact and control of acoustic absorption are essential in Educational and Sports environments. They are vital for concentration whilst providing comfort and security.

To fulfill these requirements, Eurocoustic has developed "Impact 15" and "Impact 30" systems, tested in accordance with EN 13964 - Annex D. These systems combine Acoustichoc® Panels with hold down clips and cross tee fasteners, which guarantee both the aesthetic and resistance of the ceiling.

- **Impact 15 for medium shocks:** game rooms, changing rooms, washrooms, fitness rooms, dance halls, kindergarden, workshops...
- **Impact 30 for strong shocks as in ball games:** sports halls, ice rinks...

Acoustichoc® panels used on their own are perfectly suitable in rooms requiring a low impact resistance or a high maintenance cycle. The additional offer of a small dimension, 600 x 600 mm, is ideal for use when smaller areas are involved such as classrooms and corridors.



## The BALL TEST

### EN 13964 - Annex D

This standard defines 3 classes for impact resistance:

Classes	Impact resistance at a speed of	Equal to
<b>1A</b>	16.5 m/s	60 Km/h
<b>2A</b>	8 m/s	30 Km/h
<b>3A</b>	4 m/s	15 Km/h

### TEST METHOD

**36 throws with** a hand ball using a cannon:

- 12 times vertically
- 12 times at an angle of 60° from two perpendicular directions

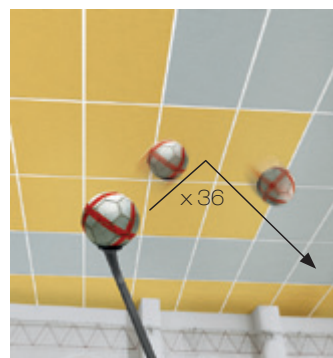

**Requirements to achieve a class:** "the resistance, purpose and security of the suspended ceiling must not be critically affected and its appearance must not change noticeably".



An offer  
dedicated to specific environments

## EDUCATIONAL

---

### Acoustichoc® Ceiling

- Classrooms
- Corridors



### Acoustichoc® Impact 15 Ceiling

- |                  |                       |
|------------------|-----------------------|
| • Changing rooms | • Rest and Game rooms |
| • Workshops      | • Play rooms          |
| • Washrooms      | • Kindergartens       |



# SPORTS ENVIRONMENT



## Acoustichoc® Ceiling

- Corridors



## Acoustichoc® Impact 15 Ceiling

- Changing rooms
- Washrooms
- Dance Halls
- Fitness Halls
- Dojo



## Acoustichoc® Impact 30 Ceiling

- Sports halls & Gymnasium (handball, tennis, volleyball, basket, football...)
- Ice rinks (ice hockey)







# Impact Resistance Systems

Acoustichoc® Ceiling

**IMPACT  
15**

600 x 600 x 25 mm

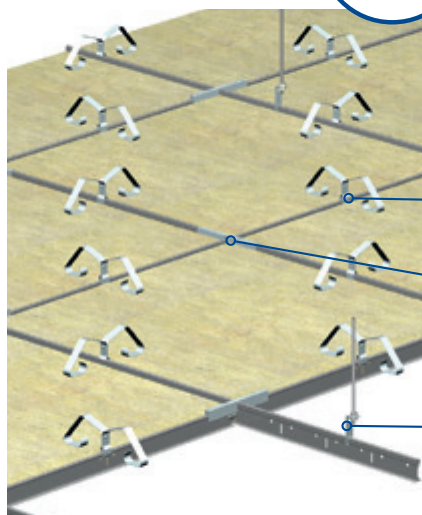

- Main runner T24 every 1200 mm
- Perpendicularly, every 600 mm, cross tees in 1200 mm
- Cross tees in 600 mm for 600 mm panels

• 6 Euroclips per m<sup>2</sup>

• 4 Fasteners per m<sup>2</sup>

• Quality standard grid system

Acoustichoc® Ceiling

**IMPACT  
30**

1200 x 600 x 40 mm

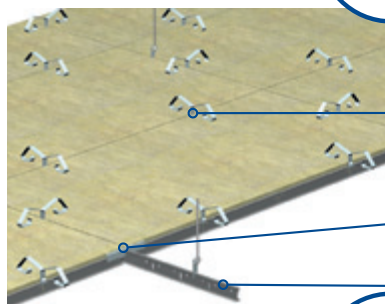

- Main runner T24 every 1200 mm
- Perpendicularly, every 600 mm, cross tees in 1200 mm

• 5 Euroclips per m<sup>2</sup>

• 3 Fasteners per m<sup>2</sup>

• Quality standard grid system

Acoustichoc® Ceiling

**IMPACT  
30**

1500 x 1000 x 50 mm

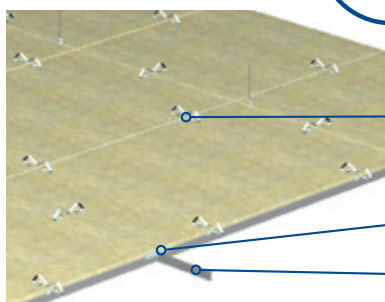

- Main runner T24 or T35 every 1500 mm
- Perpendicularly, every 1000 mm, cross tees in 1500 mm

• 2 Euroclips per m<sup>2</sup>

• 1 Fasteners per m<sup>2</sup>

• Quality standard grid system

## CHOICE OF 7 COLORS



## IMPACT 15

Class 3A



### FOR MEDIUM IMPACT

Workshops, games rooms, kindergartens, changing rooms, washrooms, fitness rooms, dojo...

600 x 600 x 25 mm

Classification certified through the Ball Test method by the MFPA Leipzig GmbH Laboratory, Germany

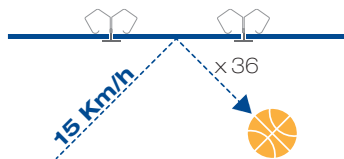

Resistant to more than 36 throws of a hand ball at a speed of 15 km/h

## IMPACT 30

Class 2A



### FOR STRONG IMPACT

Gymnasium, sports halls, ice rinks...

1200 x 600 x 40 mm  
or  
1500 x 1000 x 50 mm

Classification certified through the Ball Test method by the MFPA Leipzig GmbH Laboratory, Germany

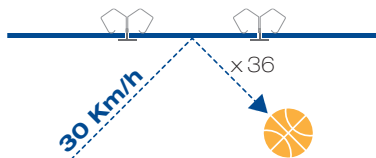

Resistant to more than 36 throws of a hand ball at a speed of 30 km/h



Black

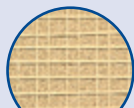

Beige

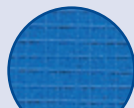

Blue

## ACOUSTICHOC® PANELS

CHOICE OF 3 SIZES  
7 COLORS

Panels are surfaced with a glass fiber tissue reinforced with a glass grid.

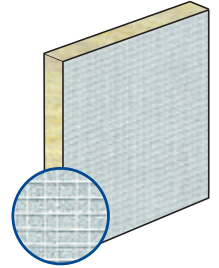

## QUALITY STANDARD GRIDS\*

T24/T35

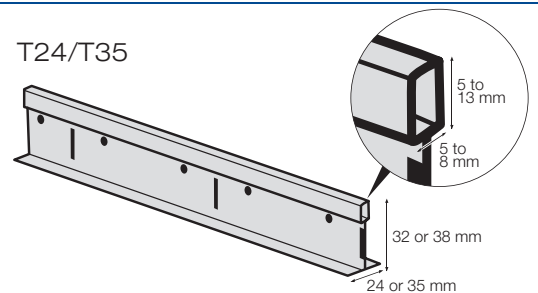

## CROSS TEE FASTENERS

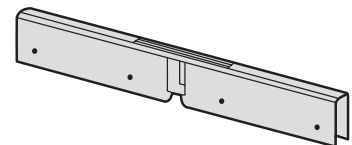

## EUROCLIPS

SUITABLE FOR PANELS 25 TO 50 mm THICK

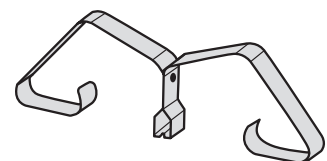

\*Dimensions indicated to be taken as guideline only. Eurocoustic cannot be held responsible for direct or indirect damage caused by their appropriation. Eurocoustic reserves the right to modify this information without prior notice.



# Acoustichoc® Panels

Acoustichoc® is a high density thermo-acoustic panel manufactured from stone wool faced with a white or colored glass fibre tissue, reinforced with a glass grid. The reverse is surfaced with a natural glass fibre tissue.



## Module Sizes



## Acoustic Absorption



## Reaction to Fire



## Humidity



## Thermal Insulation Values



## Light Reflection



## Packaging

★ NEW ★

Length	<b>600 mm</b>	1200 mm	1500 mm
Width	600 mm	600 mm	1000 mm
Thickness	<b>25 mm</b>	<b>25/40 mm</b>	50 mm

Through its enhanced absorption, Acoustichoc® provides controlled reverberation, facilitates understanding and ensures acoustic comfort.

25 mm  $\alpha_w = 0.95$ : class A

40 mm  $\alpha_w = 1$ : class A

50 mm  $\alpha_w = 1$ : class A

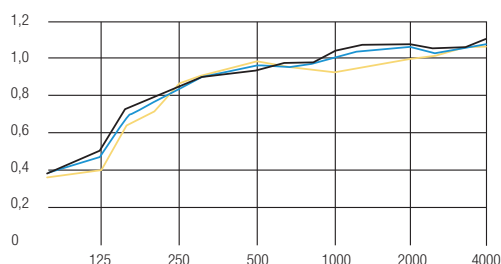

Acoustichoc® panels are classified as follows:

White: A2s1d0

Color: A1

Acoustichoc® panels are 100% stable whatever the degree of humidity.

25 mm	40 mm	50 mm
R = 0.71 m² K/W	R = 1.14 m² K/W	R = 1.43 m² K/W

White: 73 %

Size	m² /Package	Panels /Package	Packages /Pallet
600 x 600 x 25 mm	7.2	20	18
1200 x 600 x 25 mm	7.2	10	18
1200 x 600 x 40 mm	7.2	10	12
1500 x 1000 x 50 mm	6.0	4	8



All Eurocoustic packages are protected by a thermoretractable film: pallets are shrinkwrapped and must be stored under cover.



# System's Components

		Item/Package
	Cross Tee Fasteners	100
	Euroclip	100

www.eurocoustic.com

Saint-Gobain Eurocoustic  
7, place de Saverne  
92415 Courbevoie Cedex  
France  
Ph.: (+33) 1 56 37 02 40  
Fax: (+33) 1 56 37 02 69

Non contractual document, given as information only. Eurocoustic reserves the right to modify the information contained therein without any prior notice.

©diadem 02/2012