

## alubase<sup>®</sup> Aluminium Skirting

### Product Technical Statement

#### Modern Skirting Boards

Distributed by Studco Building Systems; EZ Concept Alubase Skirting board provides a modern alternative to traditional timber skirting boards. Alubase is available in three different profiles to suit modern finishes and commercial office environments; EZ Concept Alubase provides a fast and efficient solution to finishing walls. EZ Concept Alubase's anodised surface can be left as an accent feature or is ready to paint as per the requirements of AS/NZS 2311:2009, Guide to the Painting of Buildings.

#### Technical

##### Building Regulations

EZ Concept Alubase will assist and support in meeting the following provisions of the New Zealand Building Code (NZBC):

- NZBC B1 VM1 Verification Methods and Acceptable Solutions
- NZBC B2 Durability

##### NZBC Compliance

Custom EZ Concept Alubase complies with the following requirements and standards of the NZBC:

- AS/NZS 1397:2011 - Steel sheet and strip - Hot-dipped zinc-coated or aluminium/zinc-coated
- AS 1365-1986 – Tolerances for flat-rolled steel products
- AS/NZS 2311:2009 – Guide to the painting of buildings

##### Material Surface

Custom EZ Concept Alubase manufactured from durable anodised aluminium, providing strong adhesion bonding for subsequent painting of other organic coating.

##### Manufacturer's Documents

Studco recommends that all persons engaged in the installation have full knowledge of the product and installation procedure as set out in the most recent edition of the manufacturer's instructions and related documents. Manufacturer's documents relating to work in this section are:

- EZ Concept Alubase Installation Instructions
- EZY Finishing Product Catalogue
- EZ Concept Alubase Product Warranty

#### Specification

Custom EZ Concept Alubase is manufactured from anodised aluminium 1.6mm gauge material as supplied by Studco Australia, [www.studcosystems.com.au](http://www.studcosystems.com.au). Profile must be (Profile Type) made to ( )mm in height and for plasterboard thickness of (10/13mm). Fixed using a high strength construction adhesive superior formulation formed for bonding aluminium, masonite and concrete. Installed as per Studco recommendations. For guidance contact your Forman Building Systems Account Manager.

#### Alubase Shadowline

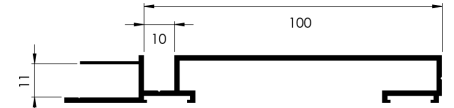
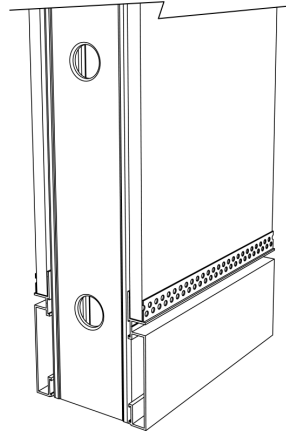

SLS1090-36 Suits 10mm plasterboard

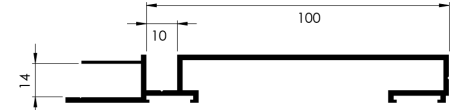

SLS1390-36 Suits 13mm plasterboard  
Available in 3600mm lengths

#### Alubase Shadowline Rubber Insert

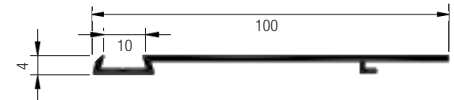
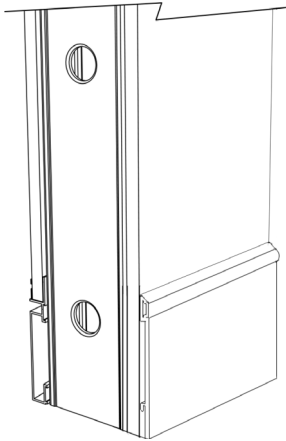

SK100BL-36 Screw fix to plasterboard  
Available in 3600mm lengths

Rubber Inserts Available in:



Available in 3600mm lengths

#### Alubase Skirting Flat

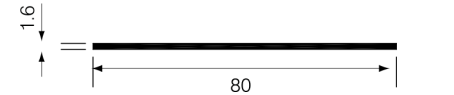
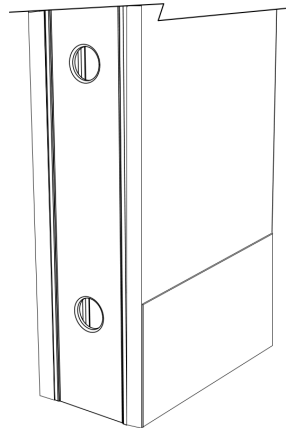

SK80-36 Direct fix to plasterboard



SK100-36 Direct fix to plasterboard  
Available in 3600mm lengths

#### EZ Concept Alubase Joiner Profiles

SK100S Corner Joiner (For SK100BL-36)	
SLSCNR Corner Joiner 10Pk (For SLS1090/ SLS1390)	
SLSJOI Straight Joiner 10Pk (For SLS1090/SLS1390)	

## Installation

Before starting installation of EZ Concept Alubase aluminium skirting, check again that the materials have been supplied as ordered and are free from damage or faults. Check product labels to ensure product has been supplied correctly. If product arrives damaged note the condition on the freight documents and contact Forman Building Systems immediately. Goods signed as received in 'good condition' will not be the responsibility of Forman Building Systems or Studco Building Systems.

### Installation

EZ Concept Alubase is to be installed after the installation of the plasterboard, when installing EZ Concept Alubase Shadowline SLS1090-36 & SLS1390-36 please allow 100mm gap between the plasterboard and the base flooring. Studco recommends the use of a high strength construction adhesive superior formulation formed for bonding aluminium, masonite and concrete to fix EZ Concept Alubase to framing and plaster board. Please speak to your Forman Building Systems Account Manager for Recommendations.

When fixing the perforated edge of EZ Concept Alubase Shadowline please use plasterboard manufacturers screw recommendations and fix at 200mm centres. Please refer to the EZ Concept Alubase install instructions for more detail.

### Alubase Joiners for Linear, External and Internal Corners

Studco recommend the use of EZ Concept Alubase joiners when joining linear sections, external and internal corners of EZ Concept Alubase Part Numbers: SK100BL-36, SLS1390-36 & SLS1090-36. Please refer to EZ Concept Alubase Install Instructions.

When installing EZ Concept Alubase Flat Skirting SK80-36 & SK100-36, apply recommended adhesive evenly across entire back of skirting to ensure an even tacked finish. When installing around corners, lightly score the inside of the corner (inside or outside edge) to ensure a tight tactful fit. EZ Concept Alubase SK80-36 & SK100-36 are designed to be glued directly on to the installed plasterboard.

### Custom Sections

Where custom sections of Shadowline are required Studco recommend specifying EZ Concept Custom Shadowline. Please speak to your Forman Building Systems representative for more detail

### Selections

For further information about Custom EZ Concept Alubase or any other Studco Product please visit [Studcosystems.com.au](http://Studcosystems.com.au) or contact your Forman Building Systems Account Manager.

### Environmental

Studco is committed to best practice through our ISO 9001 and ISO 14001 accredited Quality and Environmental Management Systems. All off cuts and excess oils incurred in the manufacturing of Studco products are re-used or recycled wherever possible.

## Warranty

EZ Concept Alubase is warranted for the period of 30 Years when installed as per the EZ Concept Alubase Installation Instructions and used in fit for purpose applications under the Studco Australia standard warranty terms.

For further information about EZY Jamb or any other Studco Product please visit [www.studcosystems.com.au](http://www.studcosystems.com.au) or contact your Forman Building Systems Account Manager. Alubase® is a registered trademark of Studco Building Systems Pty Ltd

Available from



**Studco Australia Pty Ltd**  
130 - 140 Merrindale Drive  
Croydon South VIC 3136  
Direct: +61 3 9737 2500  
[sales@studcosystems.com.au](mailto:sales@studcosystems.com.au)

