



KNAUF

Stratopanel

Linear Edge



STRATOPANEL LINEAR.

Seams too good to be true!

Knauf Australia introduces Stratopanel Linear, offering you the easiest and fastest installation of high-performance acoustic plasterboard.

Stratopanel Linear is part of the **Stratopanel** range – a trusted acoustic solution for ceilings and walls manufactured with high quality, ultra-sharp perforations in a variety of continuous perforated patterns. The range, exclusive to Knauf, meets the high level of acoustic performance required in commercial public areas such as offices, retail centres, schools, hospitals, conference halls and hospitality spaces.

Stratopanel offers a beautiful monolithic look with a seamless finish.

How is Stratopanel Linear different?

Stratopanel Linear has the same outstanding qualities offered by the standard Stratopanel UFF range, but requires no glue or jointing compound during installation. Stratopanel Linear is engineered to allow a precise fit between boards, with the micro v-joints becoming almost invisible when painted. This results in the seamless appearance you've come to expect of the Stratopanel range.

Stratopanel Linear boards come with a white pre-primed surface and do not need a sealer undercoat.



Did you know?

It is possible to install Stratopanel Linear with cap screws for some of the perforation patterns (Alternating Circular R excluded). Cap screws remove the need for setting screw heads, as screw fixings are hidden in the perforation holes, improving the appearance of the final finish. Available in 8, 10 and 12 mm diameter and also in 12 mm square.

QUICK AND EASY INSTALLATION

The benefits:

- › No gluing or jointing compound required
- › Micro v-joints become virtually invisible when painted
- › Easiest and fastest installation of acoustic plasterboard

Micro V-Joint

The micro v-joint of Stratopanel Linear is engineered to allow a precise fit between the boards.

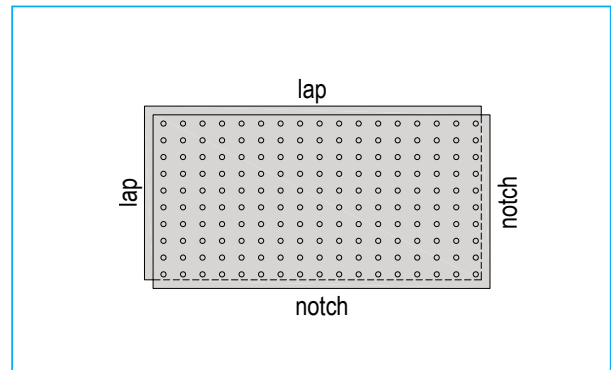
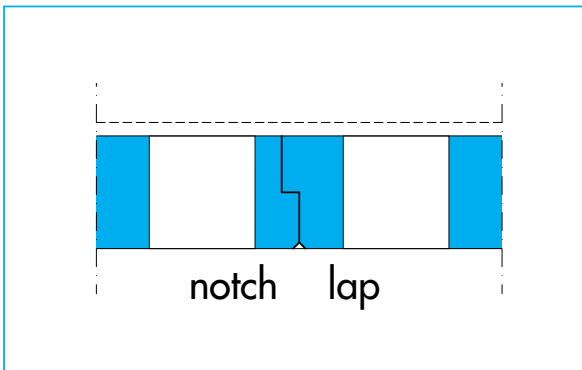

Design	Perforation pattern	Perforation ratio (%)	Board Dimensions	
Standard perforation patterns				
Circular R	8/18 R	15.5	1188	1998
	12/25 R	18.1	1200	2000
Square Q	12/25 Q	23.0	1200	2000
Alternating Circular R	12/20/66 R	19.6	1188	1980
Specialty perforation patterns				
Circular R	10/23 R	14.8	1196	2001

COMPLETE PEACE OF MIND

Knauf offers Stratopanel Linear as part of a truly complete system with the Knauf Wide Face Furring Channel and matching clips.

When you install Knauf products as a complete system in accordance to our recommendations, you have the ultimate peace of mind knowing that you are covered by the Knauf Warranty.

The Knauf Warranty covers the entire system and not only the individual products, offering complete peace of mind to everyone involved in the project.

Knauf components and systems have been tested and/or assessed by independent testing laboratories and/or suitably qualified professionals to comply with the requirements of the National Construction Code (NCC) and relevant Australian Standards.

Specialty Framing Systems

Wide Faced Furring Channel

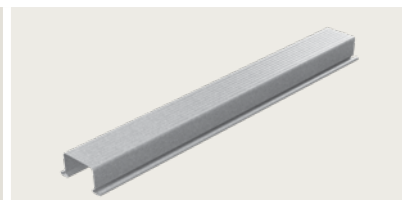

Clips

Wide Faced Furring Channel Direct Fix 80 and 180



Wide Furring Channel Anchor Clip 7.5mm Hole



Wide Furring Channel to Top Cross Rail - Klik Clak



"Stratopanel Linear is the ideal solution when you have limited time to finish your project," says National Architectural Manager (Specification and Design) Nazli Almasirad.

"It is the fastest and easiest way to install high quality acoustic board. Depending on the chosen perforation it only requires cap screws during installation. This means no jointing or gluing," says Nazli.

Due to a tight construction program Stratopanel Linear was a natural choice in the construction of Melbourne Water's headquarters, located in the Docklands area of Melbourne. The building was designed by the international design firm Woods Bagot.

"The product was used in an open-plan area and the product helped to improve the acoustic comfort, without compromising the clean monolithic aesthetic of the ceiling," says Nazli.

"Schools often choose to do renovations over the Christmas holiday period, and the ease of installation of Stratopanel Linear makes it a good solution when time is of the essence.

"Furthermore it may be possible to mount and demount the panels for re-use, making it the ideal solution in rented spaces such as restaurants.

"The unique micro v-joints ensure a perfect fit between the boards, enabling Stratopanel Linear to offer the same beautiful monolithic look that customers have come to expect of the Stratopanel range," she says.

"What I love about Stratopanel is that it improves the quality of the air while improving the acoustics of indoor spaces – a clear win for any room!

"Knauf offers Stratopanel Linear as part of a complete system with the Knauf Wide Face Furring Channel and matching clips, so there's no running around to get hold of all the components required. This also means that customers who install it as a complete system can enjoy the further assurance of the Knauf Warranty."



A BREATH OF FRESH AIR

Air purification built in

Studies show that we spend up to 90% of our time indoors, but unfortunately the air quality in many buildings and workspaces is poor.

There are many pollutants that contaminate the air we breathe. Some are noticeable odours originating from smoking rooms, kitchens and bathrooms, but there can be other, more hazardous chemicals floating around in the air that aren't as evident.

Everyday substances such as paint, glue, hairspray, cleaning substances and solvents create potentially harmful emissions, including a family of chemicals called Volatile Organic Compounds (VOCs), which have been linked to allergies, asthma and even cancer.

To make matters worse many new buildings are designed to be as airtight as possible for increased energy efficiency. While effective at retaining heat, an airtight design can trap pollutants, allowing the contaminants in the air to build up.

As with all products in the Stratopanel range, Stratopanel Linear incorporates CLEANEO technology to improve the air quality of indoor spaces. CLEANEO contains dehydrated zeolite, an aggregate mineral with a nanoporous structure.

Together with gypsum, zeolite creates a large inner layer of plaster surfaces within the Stratopanel board itself. This inner layer works to reduce both smells and airborne pollutants such as VOCs.

The air is purified as it streams through the perforations in the board, removing unpleasant pollutants and leaving the air cleaner. It is this unique technology that lies at the heart of products in the Stratopanel range.



Did you know?

VOCs are carbon-based chemicals that easily evaporate at room temperature. They are found in many common household materials and products, such as paints and cleaning products. Studies suggest that breathing low levels of VOCs for long periods of time may aggravate symptoms in people who have asthma or are sensitive to chemicals.



We're social...follow us on



KNAUF BLUEPRINT

Knauf Blueprint is our system manual for steel framed wall & ceiling systems. Quick and simple to navigate and with testing details of Knauf's numerous systems included, your peace of mind regarding system compliance is assured.

Our team of engineers and product & system specialists are available to assist you at every stage of your project through planning, calculation and implementation. Access Knauf's technical documentation, calculation & BIM tools and system selectors which are all available online 24/7 at www.knauf.solutions. Benefit from the extensive experience of our team of experts to ensure you meet your compliance and safety requirements. Take advantage of our CPD architect education program or our project specific K-Spec proposals.

KNAUFknowhow



Knauf Plasterboard Pty Ltd

ABN 61 003 621 010

31 Military Road

Matraville NSW 2036

Customer Service 1300 724 505

knauf.solutions



Knauf Warranty

Knauf's products are supported by a 10 Year Warranty.

For details visit

knauf.solutions/warranty

Technical Advice 1300 724 505